



46 Waratah Street Kyle Bay NSW

3  2  2 

Nestled with fantastic open views across Kyle Bay, this solid family home occupies a commanding position in a blue-ribbon street and offers huge scope for future enhancement. Designed on a generous scale, the residence boasts well-proportioned rooms and oversized picture windows throughout creating a welcoming sense of space and light, while the elevated front deck captures summer breezes and magical sunsets. Close to local amenities such as scenic Kyle Williams Reserve and Connells Point & Bald Face Public Schools.

Type : House
Price : \$ 1,540,000
Land Size : 765 sqm
View : <https://www.luxebyymm.com.au/sale/nsw/st-george/kyle-bay/residential/house/5884914>

Fashionable mid-century modern style lounge boasts wraparound bay-facing windows and flows to dining and large original kitchen with dishwasher and induction cooking. The spacious ground-level bedroom lends itself to

[For full version visit the website](#)

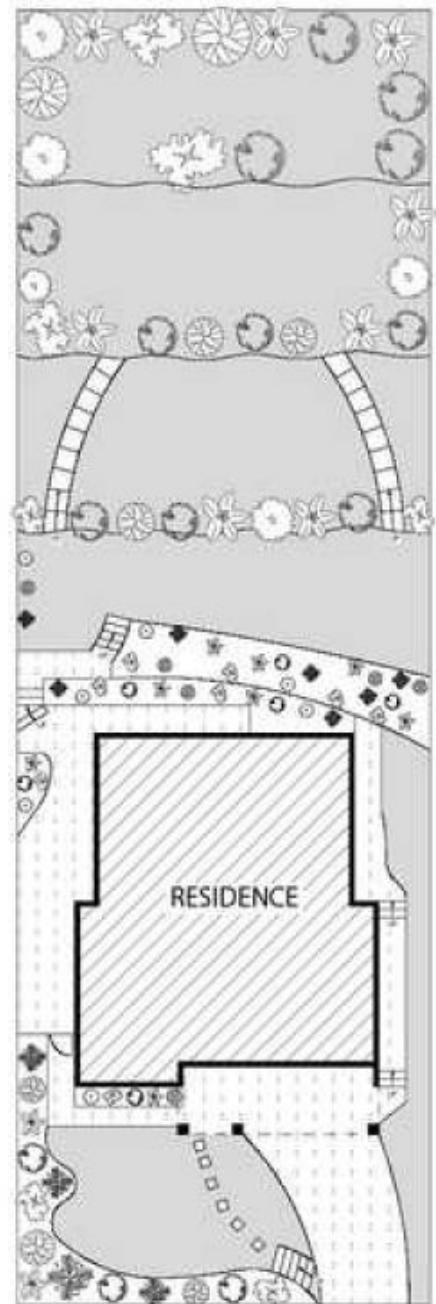
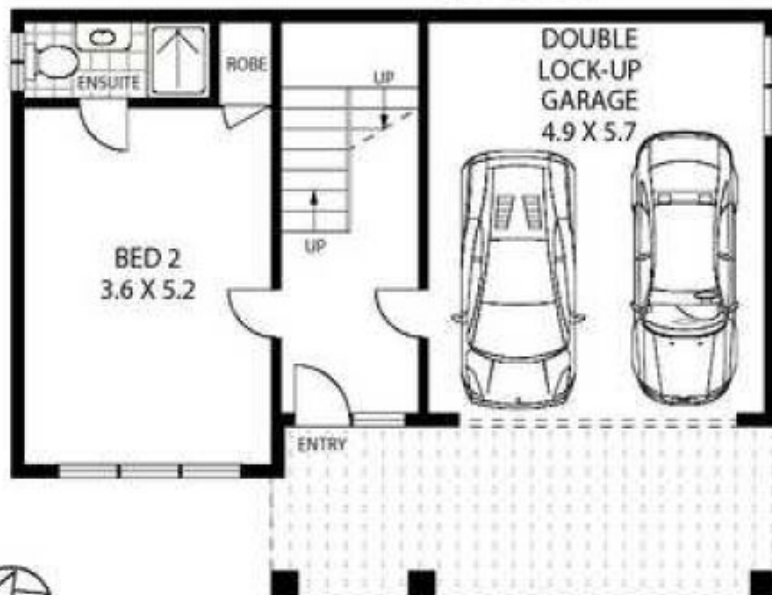

APPROX : TOTAL INTERNAL AREA :- 157 SQM
 APPROX : GARAGE AREA :- 28 SQM



46 WARATAH STREET

KYLE BAY

Floor Plan Disclaimer: Mind the Gap (ntg) floor plans / site plans are intended as an approximate guide only. No representations or warranties of any nature are given or intended and any person using this information other than as a guide should always rely on their own enquiries. Mind the Gap property marketing services / 1300 133 143 / Photography, Floor plans, Copywriting, Video, Online, Design / www.mindthegap.com.au