





9 Lachlan Avenue Sylvania Waters NSW

3  3  2 

Lifestyle - With imposing street appeal, this executive residence offers contemporary family living in a highly sought-after waterfront street and enjoys spectacular open water views to the north. Offering a warm, sun-filled and luxuriously appointed interior, this home provides first floor open plan lounge/dining which overlooks the entertaining balcony and child-friendly back yard to the moored boats and water beyond, and a separate ground floor rumpus which gives access to the covered barbecue area and landscaped garden

Accommodation - Entry into an impressive double-height foyer leads to the first floor which features quality kitchen overlooking open plan lounge/dining/family, two entertaining balconies. An enormous master bedroom suite

Type : House

Price : \$ 2,050,000

View : <https://www.luxebymm.com.au/sale/nsw/sutherland/sylvania-waters/residential/house/5884995>



Maurice Maroon
02 9547 0008

[For full version visit the website](https://www.luxebymm.com.au)

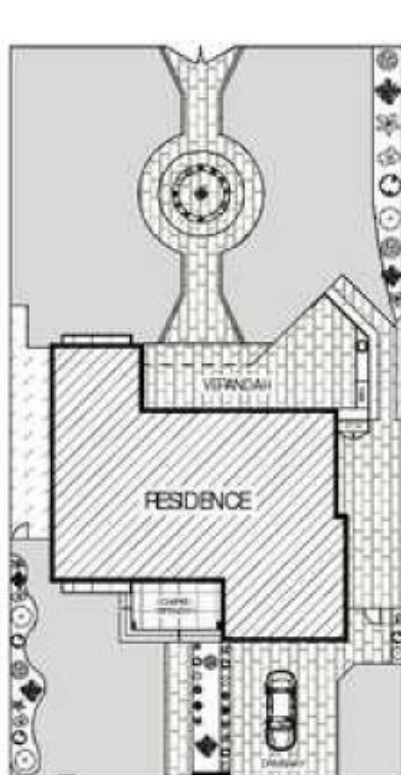

SITE PLAN



LEVEL ONE



GROUND LEVEL



APPROX : TOTAL INTERNAL AREA : 236 SQM
APPROX : GARAGE AREA : 36 SQM

9 LACHLAN AVENUE

SYLVANIA WATERS

Floor Plan Disclaimer: Mind the Gap (Int'l) floor plans/ site plans are intended as an approximate guide only. No representations or warranties of any nature are given as intended and any person using this information other than as a guide should always rely on their own enquiries. Mind the Gap property marketing services: 1300 133 146 / Photography, Floor plans, Copywriting, Video, Online, Design / www.mindthegap.com.au