



**3 Putland Close Kirrawee NSW**

3  2  2 

Charming Family Home in Prime Kirrawee Location - First Time Offered in 50 Years

This much-loved, original home is nestled in a quiet cul-de-sac and now being offered for the first time in five decades. With 3 bedrooms and 4th as a study, 2 bathrooms, and a spacious 2-car garage, this classic residence is brimming with potential, offering the perfect canvas for you to add your personal touch and transform it into your dream home.

Positioned opposite Kirrawee High School and overlooking the tranquil National Park, this home combines peaceful living with prime convenience. Located close to local transport options and the vibrant South Village precinct, it's

**Type** : House  
**Price** : For Sale  
**Land Size** : 575.4 sqm  
**View** : <https://www.luxebyymm.com.au/sale/nsw/sutherland/kirrawee/residential/house/8177867>



**Lucy Stylianou**  
02 9547 0008



**Larissa Stylianou**  
02 9547 0008

[For full version visit the website](#)

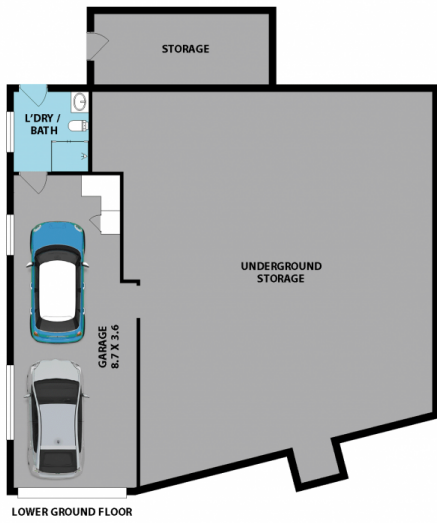

### 3 Putland Cl, Kirrawee

Floor plan produced by ENFORCEFX.COM - All measurements are approximate. Floor plan is not to scale. All information contained here is believed to be reliable, however we cannot guarantee the accuracy and interested persons should rely on their own enquiries.

